

scanomat

Pre-Installation Guide TopBrewer Compact

Handcrafted in Denmark.





Overview	3
Cupboard Dimensions	4
Ventilation	5
Benchtop Cut-outs	6
Drip tray, countersunk	8
Drip tray, top-mounted	9
Checklist	10

Overview

TopBrewer Compact



The diagram to the right is a visual example of a completed installation inside the cupboard for an ideal situation. Below is a list of **mandatory** pre-installation requirements that need to be met before we can proceed with install:

1. Electrical and water services must be easily accessible for quick isolation in case of emergency.
2. Electrical and water services must be installed in locations highlighted in diagram on page 4 to allow room for units.
3. Minimum cupboard dimensions must be allowed, including extra height if installing optional safe tray.
4. Adequate ventilation must be provided as per page 5.
5. Benchtop holes must be cut to specifications on page 6 - 9 and, where possible, checked with actual parts to be installed.

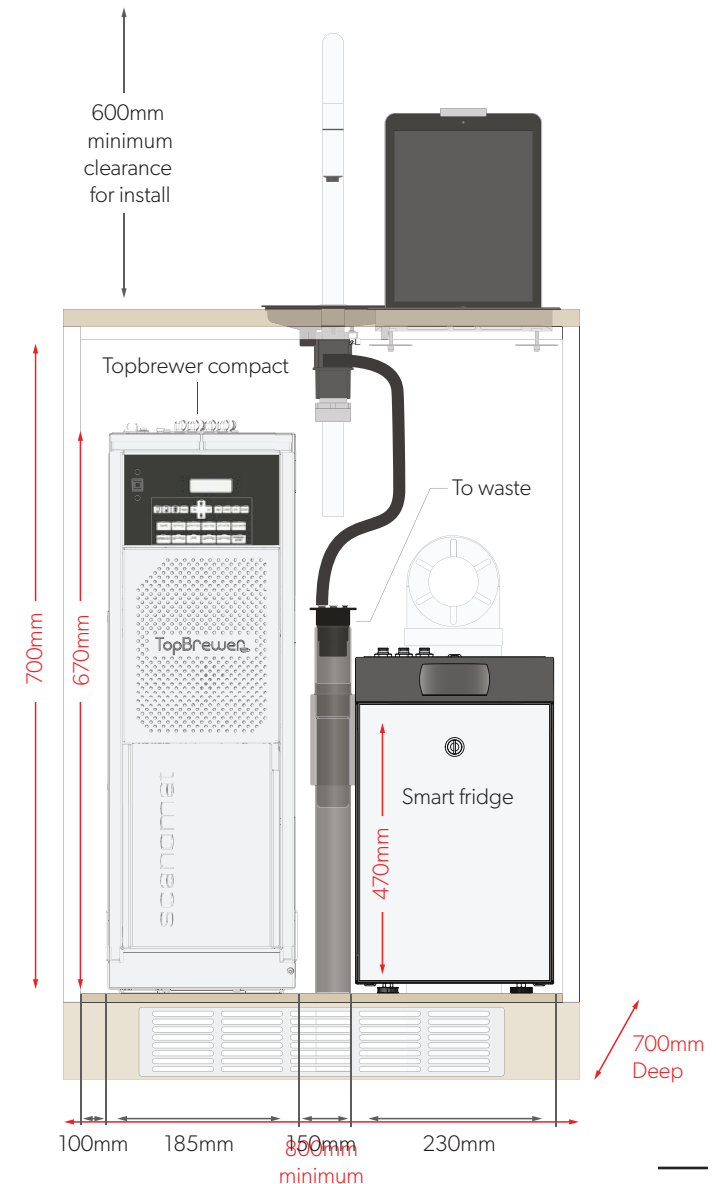

Cupboard Dimensions

TopBrewer Compact



- All dimensions listed in red are internal
- Cupboard depth → 700mm
- Water supply and waste line should be installed against back wall of cupboard

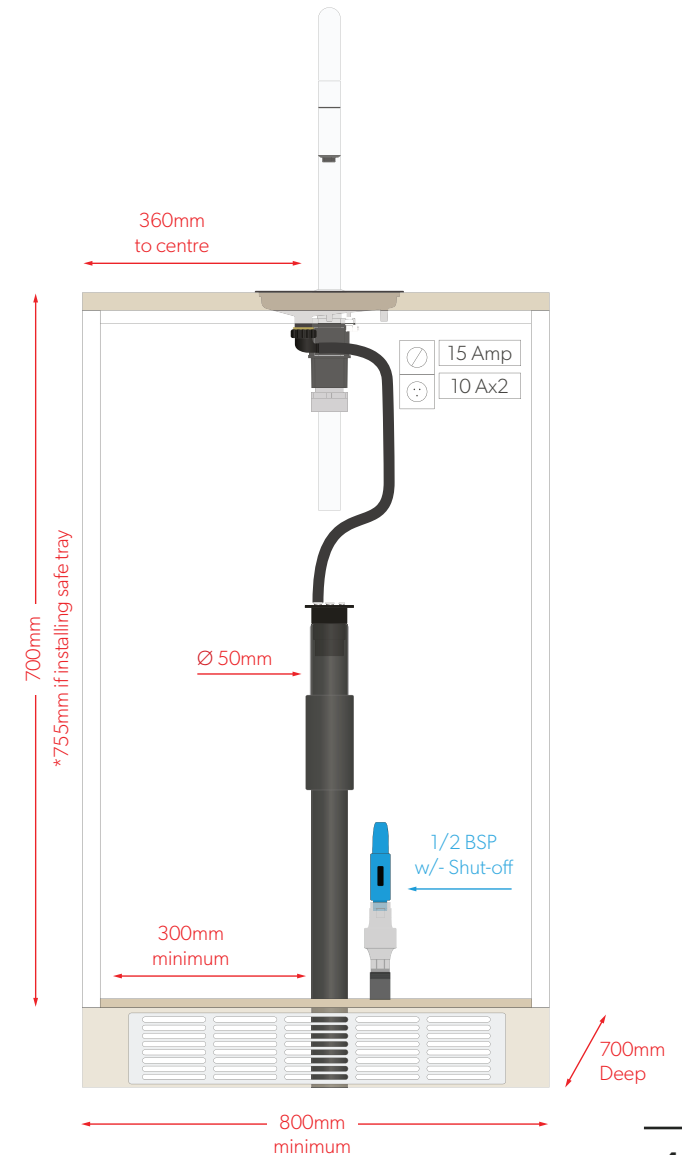

Ventilation

TopBrewer Compact



Adequate Ventilation is a requirement for Top Brewer. The equipment generates heat that needs to vent out the cupboards. To enable air circulation, ventilation is required in top and bottom of cupboard.

Scalloping the base cupboard and routing ventilation in the top of the cupboard doors will be adequate ventilation for cool air to be drawn in and hot air to escape up and out. These cuts MUST always be at the very top of the cupboard

We recommend the routed vents be 300mm – 400mm in length, and 20mm in height. Scalloping should be at least 20mm into the base of the cupboard.

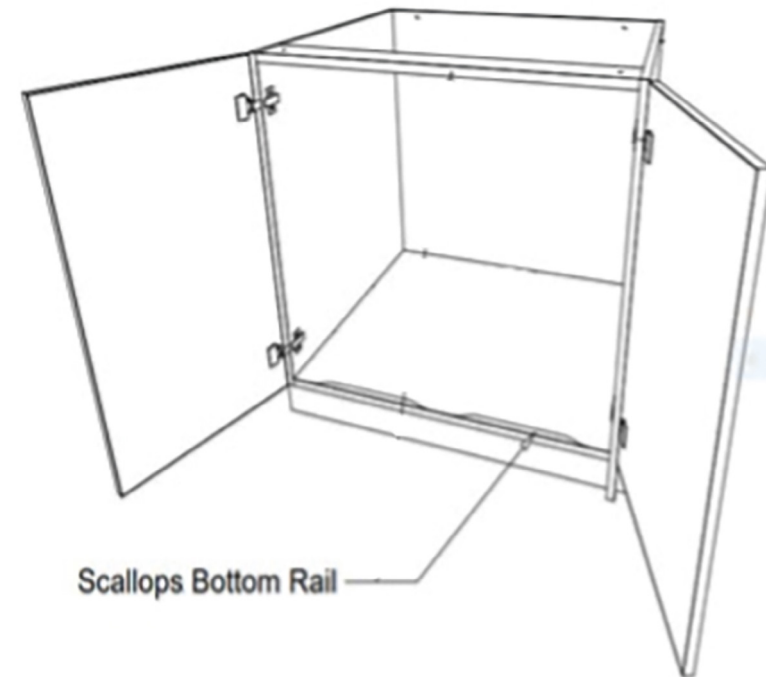

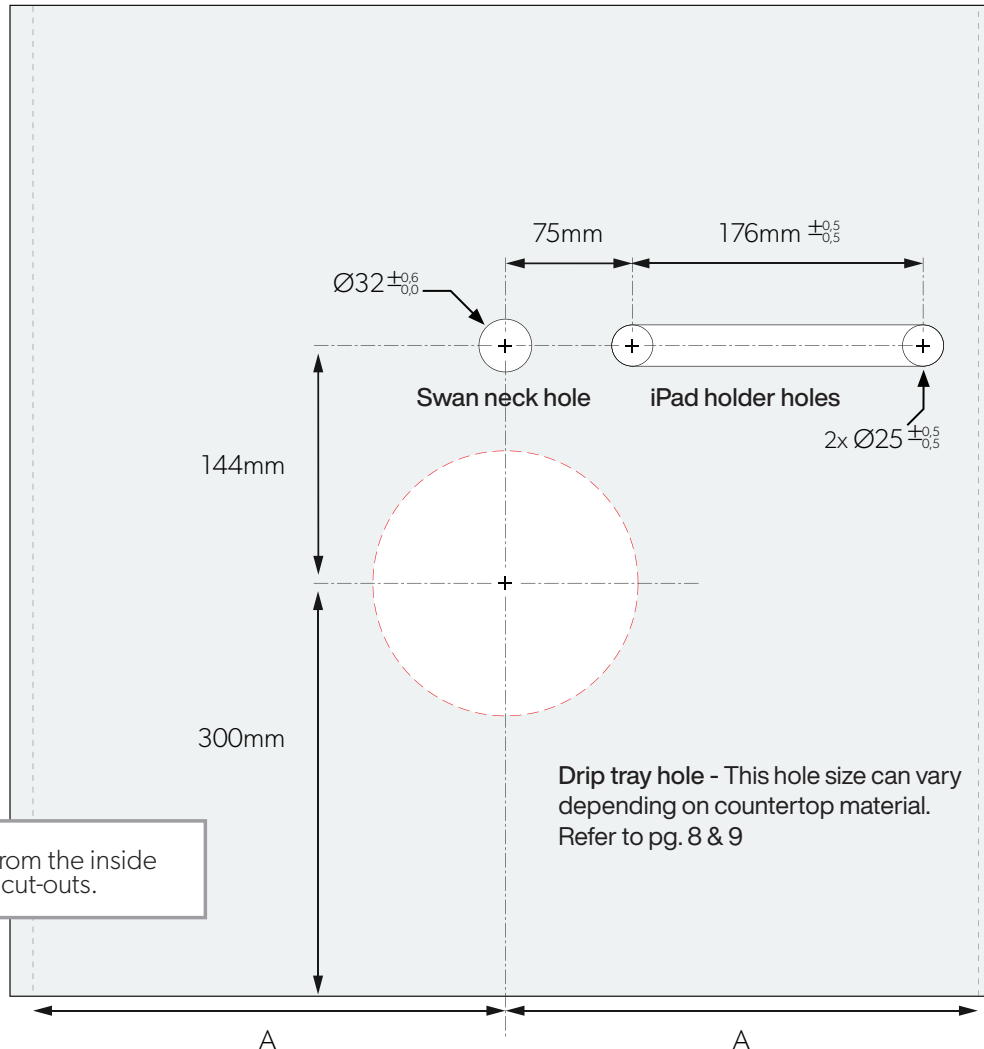

Print on A4 to give actual size of iPad holder holes.
Centre for drip tray/swan neck : 370 mm from left side of inside of cupboard wall

Benchtop Cut-Out Requirements - iPad Deluxe Holder TopBrewer Compact

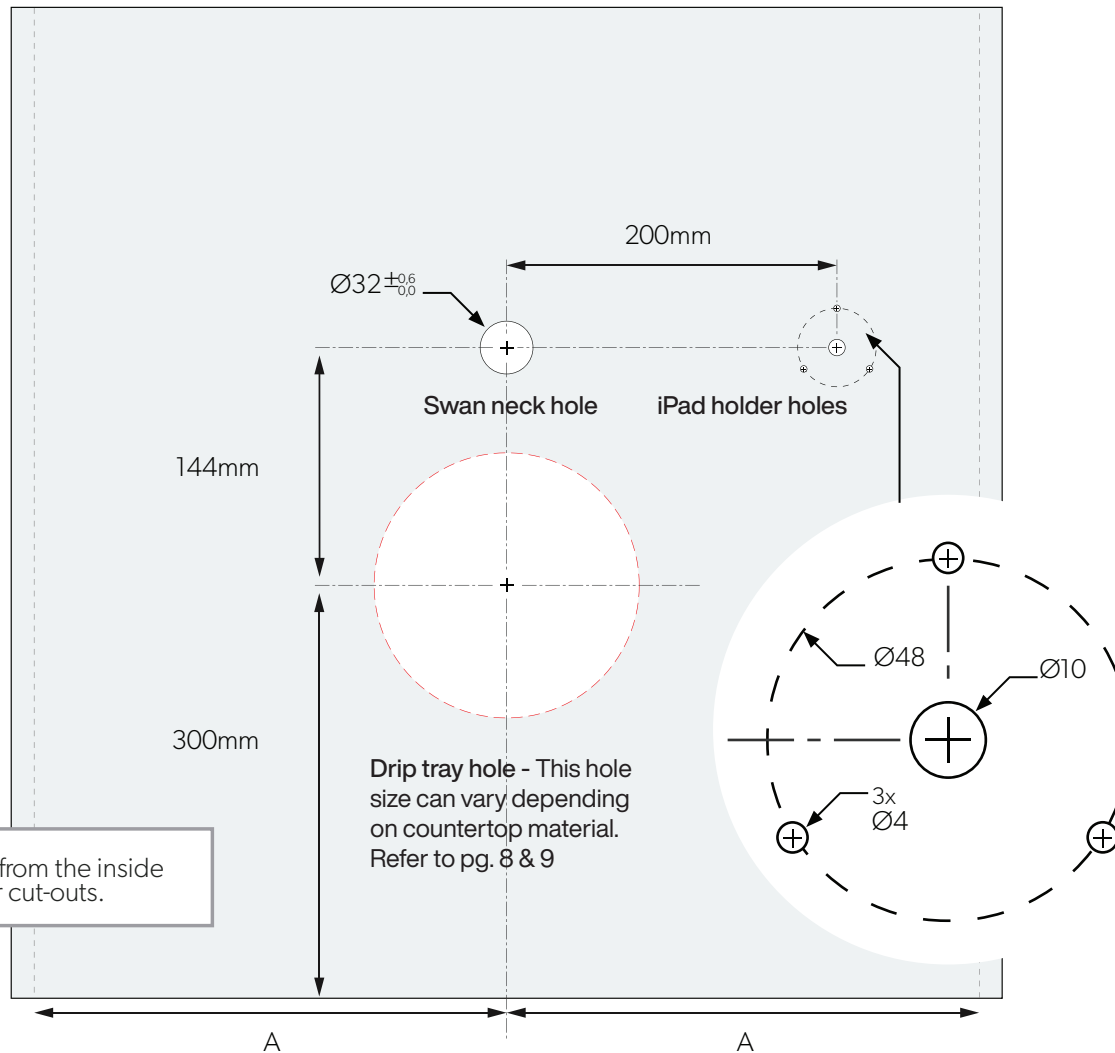

Always measure from the inside of the cabinet for cut-outs.

Template

Print on A4 to give actual size of iPad holder holes.
Centre for drip tray/swan neck : 370 mm from left side of inside of cupboard wall

Drip Tray – Flush-Mounted TopBrewer Compact

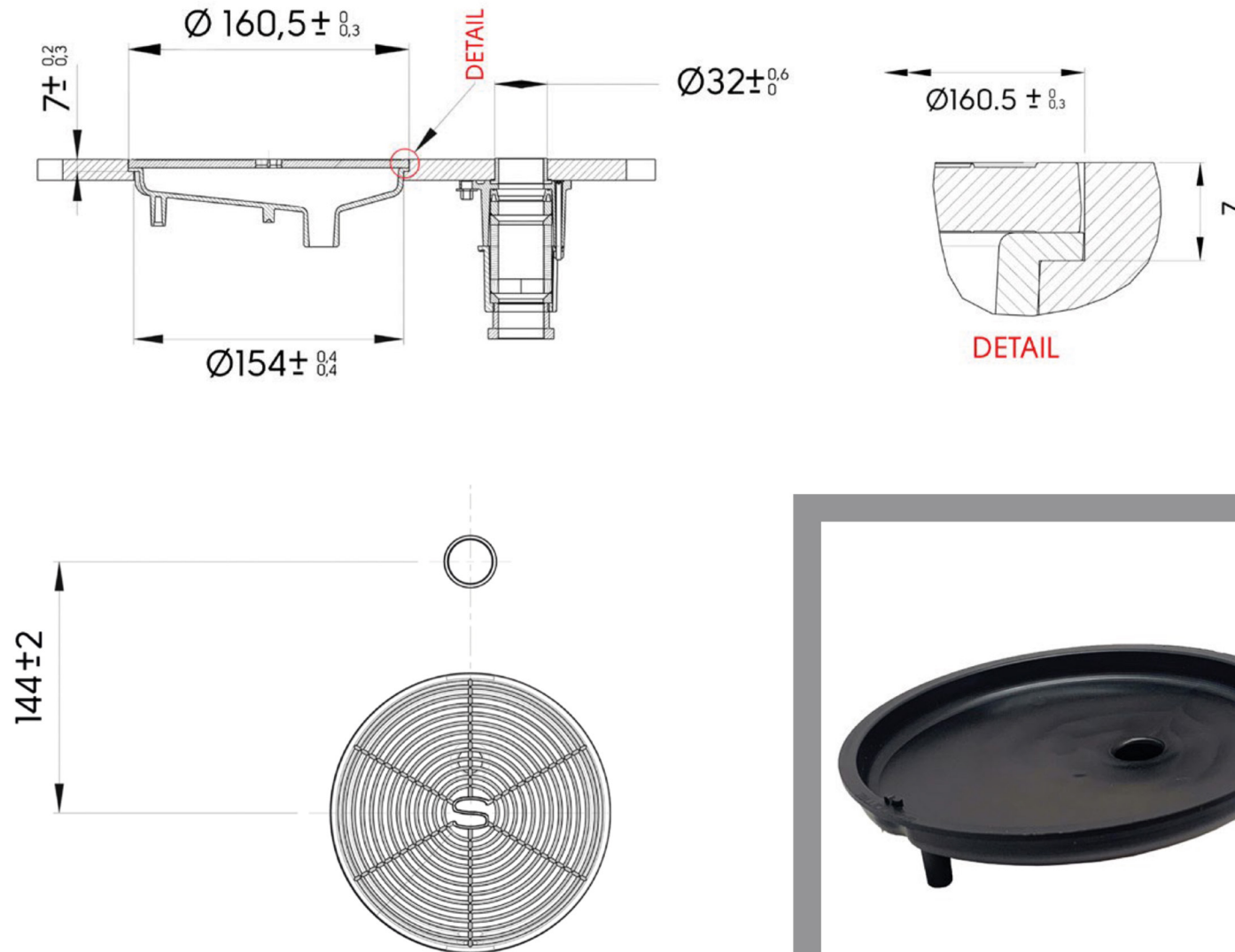

SKU: 2006162

Choose this option for solid materials such as stone, corian, composites and similar.

Alternatively, see page 8 for the Top-Mounted version.

Aesthetically the more pleasing solution.

Drip Tray – Top-Mounted TopBrewer Compact

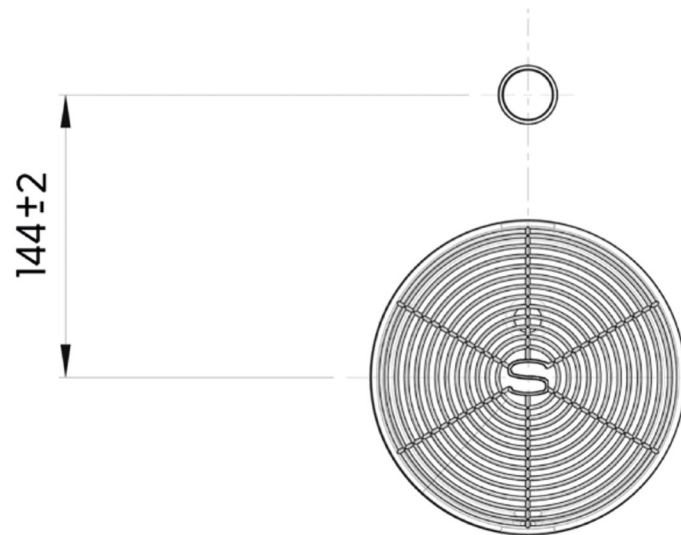
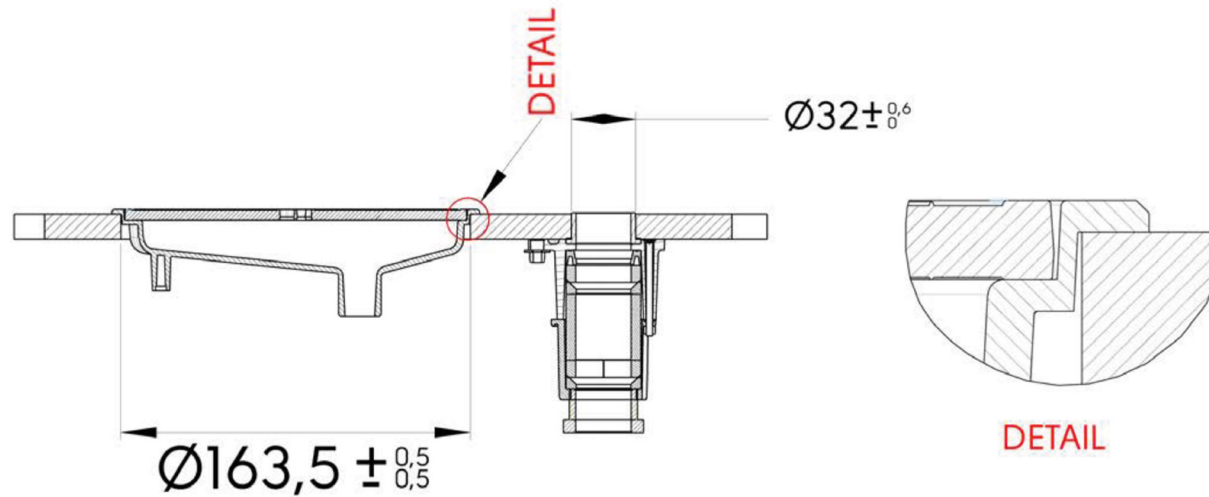

SKU: 2006162a

Choose this option for solid materials such as steel countertops, veneer wood tops, non-solid woods and such.

Alternatively, see page 7 for the Countersunk version.

Easier to cut and to seal for materials with open pores.

Pre-Installation Checklist

TopBrewer Compact



Electrical Connection

	1 x 15A industrial plug, 3pin flat with switch socket
	1 x 10A double GPO
	Within cupboard of machine
	Above the height of fridge as per diagram
	All Electrical must comply with AS/NZS3000

Water Supply

	1 x dedicated ½" BSP male fitting with shut off valve
	Water pressure at least 250kPa
	Water system must comply with AS/NZS3500.1

Waste

	Vertical Ø50mm waste stack with standard u-bend, p-trap, or inline waterless trap and tun dish
	Wastewater system must comply with AS/NZS3500.2

Cabinetry

	Internal dimensions of minimum 800mm x 700mm x 700mm (WxDxH), OR:
	Internal dimensions of minimum 800mm x 700mm x 755mm (WxDxH) if installing with optional safe tray

Ventilation

	Adequate ventilation provided (see page 5)
--	--

Drip tray cut-out

	Flush-mounted: Ø160.5mm/Ø154mm, countersunk hole (see page 7), OR:
	Top-mounted: Ø163.5mm hole (see page 8)

Swan neck hole

	Ø32mm hole
--	------------

iPad Holder

	Ø20 mm hole for cable + 3 screw holes (see page 6)
--	--



Signed off by:

Signature

Name

Date



A beverage
revolution on tap.

scanomat.com/au